





CEILING SPECIFICATION LEGEND

CEILING DESIGN REQUIREMENT: CONCEAL ALL BEAMS WITHIN THE CEILING CAVITY.
FINAL CEILING LAYOUT AND DETAILS TO BE CONFIRMED AFTER THOROUGH INVESTIGATION AND REMOVAL OF THE EXISTING CEILING.

	NEW BRICKWORK
	NEW BULKHEAD CEILING EXISTING CEILING HT 2372mm (area +/- 53 sqm)
	NEW GYPSUM CEILING BOARD - DETAILS TO FOLLOW AFTER INVESTIGATION. EX CEILING HT @ 2605mm (area +/- 209 sqm)
	NEW GYPSUM CEILING BOARD EXISTING CEILING HT @ 2650mm (area +/- 93 sqm)

NOTE: RESPONSIBILITIES FOR ELECTRICAL, FIRE, AIR CONDITIONING, AND SOUND SYSTEMS ARE EXCLUDED FROM THE CONTRACTOR AWARDED THE TENDER. THESE SERVICES MUST BE COMPLETED BY THE CLIENT'S PREFERRED CONTRACTORS. THE CLIENT SHOULD ENGAGE THEIR EXISTING CONTRACTORS AFTER THE REMOVAL OF THE EXISTING CEILINGS.

GENERAL NOTES:

Existing Conditions:
The existing ceiling must be removed and carefully investigated before the final ceiling design layout can be released. Note that all existing conditions must be assessed before commencing work, and any discrepancies should be reported to the project manager.

Safety Compliance:
All work must adhere to relevant safety regulations and standards.

Material Specifications:
List all required materials and their specifications to ensure quality and compatibility with existing structures.

Access Requirements:
Specify any access points needed for equipment and personnel during construction.

Quality Control:
Implement quality control measures to ensure all work meets design specifications and standards.

Communication Protocol:
Establish clear lines of communication between all parties involved in the project.

Contingency Plans:
Include notes on handling unforeseen circumstances or changes in project scope.

Quantity:
All quantities and areas to be checked prior to work been undertaken

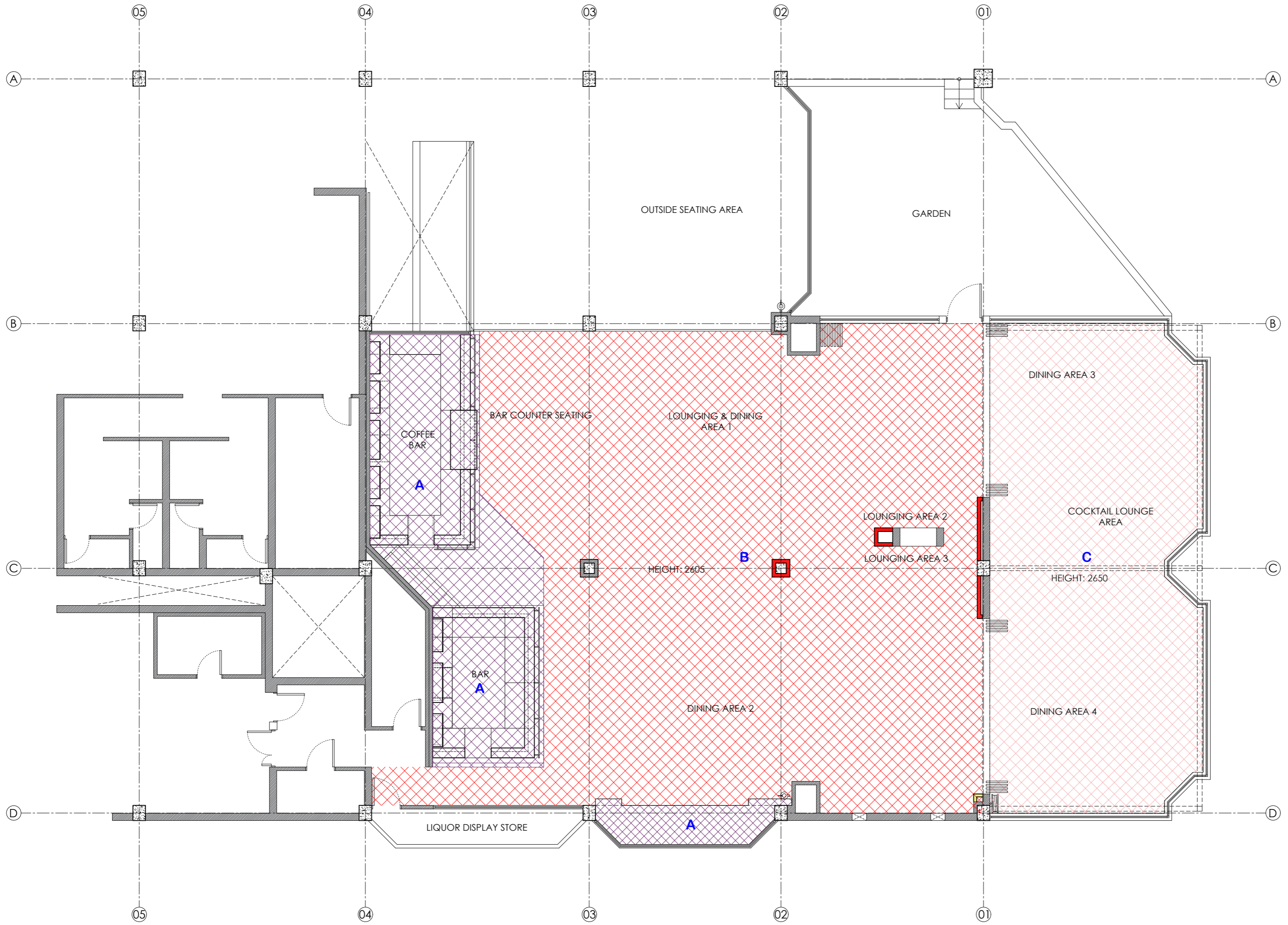

GROUND FLOOR PLAN - PROPOSED CEILING
SCALE 1.100 A2

DATE:	REFERENCE:	DESCRIPTION:
PROJECT TITLE: STAGES - THE THEATRE RESTAURANT		
DRAWING TITLE: GROUND FLOOR: CEILING LAYOUT		
DRAWING NO: STAGES-FP-CEIL-004	REV: 0	
DATE: 01 October 2024	SCALE: 1.100 A2	
DRAWN BY: Cindy L Jasmin	ISSUED FOR TENDER	
OWNERS NAME & SIGNATURE:		

DOLCE VITA
DESIGNS BY BIANCA
INTERIOR ARCHITECTURE | DESIGN | DECORATING
BIANCA SUTTNER
REGUEIRAS
PHONE: +27 82 308 1653
EMAIL: BIANCA@DOLCEVITA.COM
WEB: dolcevita.com
Postnet Suite 438 Private bag x1
Melrose Arch 2076 South Africa

APD
ARCHITECTURE
TEL: 083 793 0377 | EMAIL:
ARCHITECTURE.APD@GMAIL.COM
REG NO: CK20091106268/23
MEMBERS: CINDY JASMIN |
SACAP REG: PR ARCT - T0732